

On the Rocks



A Newsletter of the Michigan Basin Geological Society

2006-2007 Number 8

www.mbgs.org

April 2007

EVENTS

April 9, 2007: **SPE Meeting**, Mark A. Proett of Halliburton Energy Services will discuss 'Formation Testing in the Dynamic Drilling Environment'

April 11, 2007: **MBGS Meeting** and **Pig Roast** will be held at the **Core Lab Facility** at Western Michigan University. **Dr. Michael Grammer** will present, 'A Submersible Tour Along the Margins of the Great Bahamas Bank,' and the Core Lab will be open for attendees to view the facilities, see map below.

May 4, 2007: Carbonate Reservoir Characterization Workshop and Short Course at the Core Lab Facility at WMU, see info below.

May 5, 2007: The **Detroit Salt Mine trip** is **FULL** with a waiting list.

May 9, 2007: **MBGS Meeting**, the speaker is **E.Z. Manos** who will discuss some interesting insights about the Detroit Salt Mine. This will be a great follow-up to the field trip on May, 5. Additional info next month.

Tentative upcoming field trip:

Baraboo – with Robb Gillespie, Possibly 3rd weekend in Sept. 2007, Friday – Sunday

Scholarship Time Again

The Michigan Basin Geological Society will award one or more scholarships of up to \$500 to deserving student(s) majoring in the Geological Sciences. The scholarship will be awarded in May of 2007. Candidates should use a **modified** AAPG "Grants in Aid" form to submit their application. Preference will be given for student research in the Michigan Basin. If you have any questions or need application forms please **call or e-mail Thomas Godbold at 517-241-1545 or godboldt@michigan.gov**
Applications due to Thomas Godbold by April 11, 2007.

2006-2007 MBGS Officers

The Executive Committee meeting minutes are available on our website at www.mbgs.org

PRESIDENT: ROBERT REYNOLDS,
Reynolds Geological, LLC
509 Hall Blvd. Mason, MI 48854
517-676-9936, fax 517-676-8169,
reynoldsgeo@voyager.net

VICE PRESIDENT: MARK NIDA
LEG, Public Service Commission
PO Box 30221, Lansing MI 48909
517-241-6136, fax 517-241-6121,
mcnida@michigan.gov

SECRETARY: KEN PETRIE
Aurora Energy
1951 Penobscot Drive
Okemos, MI 48864
517-347-3043 kmpetrie@yahoo.com

TREASURER & PUBLICATIONS:
TOM HOANE FMFM, DNR
P.O. Box 30452, Lansing, MI 48909-7952
Bus 517-241-3769, fax 517-373-2443
hoanet@michigan.gov

BUSINESS MANAGER:
TOM GODBOLD OGS, DEQ
P.O. Box 30256, Lansing, MI 48909-7756
Ph: 517-241-1545, Fax 517-241-1595
godboldt@michigan.gov

PAST-PRESIDENT: DR. ROBB GILLESPIE
WMU Geology Department
1123 Rood Hall, WMU, Kalamazoo, MI 49008
269-378-5354, fax 269-387-5513
robb.gillespie@wmich.edu

CO-FIELDTRIP DIRECTORS:
MARK WOLLENSAK, CPG
Hamp, Mathews & Assoc, Inc.
15266 Ann Drive, Bath, MI 48808
Ph: 517-641-7333 Fax 517-641-7337
Cell 517-719-8321 wollensak@voyager.net

and

LEONARD ESPINOSA
Ph: 517-349-1917
espinosl@sbsglobal.net

NEWSLETTER EDITOR:
TOM WELLMAN, FMFM, DNR
PO Box 30452, Lansing, MI 48909-7952
Ph: 517-373-7666, Fax 517-373-2443
welldant@michigan.gov

ELECTRONIC PUBLICATIONS:
MARK WOLLENSAK

AAPG DELEGATES:
DR. AUREAL CROSS, MSU,
Dept. of Geol Sciences, 206 Natural Sciences Bldg,
East Michigan State University:
Lansing, MI 48824-1115, 517-335-4630/4639,
cross1@pilot.msu.edu

and
Dr. WILLIAM HARRISON,
Western Michigan University
616-387-8691 william.harrison_iii@wmich.edu

MEETING CANCELLATION POLICY

Monthly meetings will be automatically cancelled whenever the National Weather Service issues a "Storm Warning" for the Lansing area. If driving conditions are poor but a "Warning" has not been issued please contact any member of the Executive Committee for the status of the meeting.

MICHIGAN BASIN GEOLOGICAL SOCIETY PUBLICATIONS

Historical CD #1: Nine out-of-print publications from 1949 through 1965 and 1998, Devonian to Silurian Rock Fieldtrips to MI, WI, IL and Ontario, 2000, \$15

Historical CD #2: Four out-of-print publications from 1947, 1959, 1983 and 1991, Northern Devonian and UP Fieldtrips in MI, 2001, \$15

Historical CD #3: Six out-of-print publications from 1948, 1952, 1990 - 1995, Northern Devonian and UP Fieldtrips in MI, 2001, \$15

Historical CD #4: Six out-of-print publications from 1957, 1958, 1961, 1967, 1968 and 1970, Northern LP and UP Fieldtrips in MI, 2004, \$15

Historical CD #5: Five out-of-print publications from 1971, 1989, 2001, Southern LP, MI and Ohio Fieldtrips and **Oil & Gas Fields Vol. 1 & 2, 1969 & 1992**, 2006, \$50

Special Price - Historical CDs #1, #2, #3, #4, & #5 for \$75

NE Lower Peninsula Geological Field Conference, 2004, T. Black, M. Wollensak, 133 pp., illus., maps. On CD \$10

Stratigraphic Lexicon for Michigan, 2001, prepared by MBGS and published by DEQ, 56 pp., chart, \$2.65 picked up or \$4 mailed, Can be ordered from MBGS or Office of Geological Survey of the DEQ

Price Includes postage, handling and any applicable sales tax. Orders for publications should be prepaid in U.S. Funds and addressed to: MBGS - Publications, P O Box 18074, Lansing MI 48901-8074

MBGS Meeting April 11, 2007 (Wednesday)

New Venue and Schedule
Location: Core Lab Facility, WMU

5:30 to 6:15 PM – Facilities Open
6:15 PM – Pig Roast Dinner
Presentation after Dinner
Cost (includes Pig Roast dinner) \$25.00 (Students \$15.00)

Topic:
"A Submersible Tour Along the Margins of the Great Bahamas Bank"
by
G. Michael Grammer, PhD

Members are welcome to attend the presentation after dinner for no charge.
Please contact Thomas Godbold by **April 10, 2007** to ensure adequate seating.
Send reservations to:

Thomas Godbold
P.O. Box 30256
Lansing, MI 48909-7756
Ph: Bus Ph: 517-241-1545, Fax 517-241-1595
E-mail:godboldt@michigan.gov

Michigan Geological Repository for Research and Education
Map and Directions to 5272 W. Michigan Avenue, Kalamazoo, MI 49006--(269) 387-8633

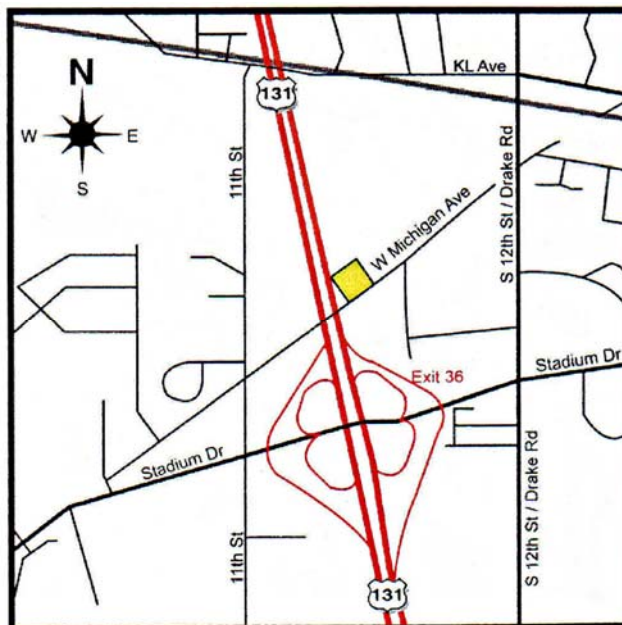

" A Submersible Tour Along the Margins of the Great Bahamas Bank"

By:

G. Michael Grammer, PhD
Western Michigan University

Biography

Mike Grammer is an Associate Professor at Western Michigan University and Director of the Michigan Geological Repository for Research and Education (MGRRE). He received his Ph.D. at the University of Miami where he worked on the modern slopes of Great Bahama Bank and did postdoctoral research on integrating sequence stratigraphy and reservoir characterization in the Paradox Basin. His current research interests include high-resolution sequence stratigraphy and reservoir characterization of carbonates and mixed carbonate/siliciclastic systems directed towards hydrocarbon exploration and exploitation. He has been an AAPG Distinguished Lecturer, has led several AAPG field courses and has published extensively on carbonate reservoir characterization issues, including as lead editor of AAPG Memoir 80 "Integration of Outcrop and Modern Analogs in Reservoir Modeling". His industry-related experience includes senior research positions with Texaco and ChevronTexaco working carbonate reservoir characterization issues in various parts of the world, most notably with super-giant fields in the former Soviet Union.

Coyote Creek Has Closed

Our recent regular meeting location at the Coyote Creek Restaurant has closed its doors. The remaining meetings for this season in April and May will be in held outside of Lansing. The Executive Committee is searching for other locations and welcomes suggestions from the membership for future meeting locations.

Seeking Nominations

The Executive Committee is assembling the ballots for next years officers. Please contact any of the officers shown on page 2 of this newsletter if you are interested in running for an office.

Carbonate Reservoir Characterization Workshop and Short Course May 4, 2007

At the Michigan Basin Core Research Laboratory, a part of the Michigan Geological Repository for Research and Education (MGRRE)
Western Michigan University
5272 W. Michigan Avenue, Kalamazoo, MI 49008-5241

This one-day workshop and short course will focus on:

1. Fundamental aspects of carbonate sedimentation, including key depositional processes and environment, facies types and diagenetic modification from the standpoint of potential reservoir quality and distribution
2. Reservoir characterization issues in the context of a sequence stratigraphic framework, which provides a valuable predictive component

We will use examples from the Michigan Basin and other petroleum basins around the world.

As a participant at this hands-on workshop, you will have an opportunity to:

- Evaluate core, cuttings and thin sections that
- Illustrate major facies types and pore architectures of typical carbonate rocks

Agenda and Program:

9:00-9:15 Welcome

9:15-4:00 Program (with breaks and lunch time)

Presenters

William B. Harrison, Professor Emeritus, and Director of the Michigan Basin Core Research Laboratory, Bill has authored dozens of papers on Michigan geology. He is part of a research team at Western Michigan University working on the origin and characteristics of dolomite in Michigan reservoirs and on the potential for geological sequestration of CO₂ in Michigan formations.

G. Michael Grammer, Associate Professor in the Department of Geosciences Director of the Michigan Geological Repository for Research and Education at Western Michigan University, Mike joined WMU in 2002. Previously, he was a senior technical consultant with Texaco and has consulted both domestically and internationally. He has been an AAPG Distinguished Lecturer, has led several AAPG field courses and has published over a hundred times on carbonate reservoir characterization issues, including as lead editor of AAPG Memoir 80 "Integration of Outcrop and Modern Analogs in Reservoir Modeling". Mike is part of a research team at Western Michigan University working on the origin and characteristics of dolomite in Michigan reservoirs and on the potential for geological sequestration of CO₂ in Michigan formations.

Course fee: \$125 includes lunch, refreshments and course notes

Workshop fee: \$125. You'll get a workbook, refreshments, and lunch. **Sorry, we can't "save" seats without payment.**

Cancellations: We'll refund in full for cancellations received by April 24. After that, we'll refund if a paid participant takes your place.

Location: Michigan Geological Repository for Research and Education (MGRRE), part of Western Michigan University, at 5272 W. Michigan Avenue, Kalamazoo, MI 49006. For a map and driving directions, please see the page following the registration form.

To register with a credit card by phone, please call Linda at (269) 387-8633 or Kathy at (269) 387-8633. To register by e-mail, contact linda.harrison@wmich.edu

To register by street mail or fax, **please use the form below.** Our FAX number is: (269) 387-5513.

Workshop Registration Form

Carbonate Reservoir Characterization

Workshop and Short Course

Michigan Basin Core Research Laboratory, a part of the
Michigan Geological Repository for Research and Education (MGRRE)
Western Michigan University
5272 W. Michigan Avenue, Kalamazoo, MI 49008-5241

NAME _____ (For your name tag)

Second registrant _____ (For name tag)

COMPANY _____

STREET OR MAILING ADDRESS _____

CITY _____ **STATE** _____ **ZIP** _____

PHONE _____ **EMAIL** _____

(Please print e-mail)

From the Kalamazoo Airport:

Exit the airport and turn right (north) onto Portage Road—go 0.2 miles to I-94
Take I-94 West toward Chicago—go 3.9 miles
Take Exit #74B/US-131 North to I-94-BUS East toward Grand Rapids—go 2.1 miles
I-94-BUS East becomes US-131 North—go 0.4 miles
Take exit #36B onto Stadium Drive (west) toward Oshtemo—go ~0.5 miles
Turn right (north) on S. 11th Street (stoplight)—go 0.1 miles
Turn right on W. Michigan Avenue (4-way stop sign)—go 0.3 miles and arrive at 5272 W. Michigan.

Our driveway is the first one just past the US-131 overpass on the left (north), through the fence gates. Our building is the largest one in this fenced area.

From the South or North

From US131, take exit #36B/Stadium Drive onto Stadium Drive, (west) towards Oshtemo—go ~0.5 miles. Turn right (north) on S. 11th Street (stoplight)—go 0.1 miles. Turn right on W. Michigan Avenue (4-way stop sign)—go 0.3 miles and arrive at 5272 W. Michigan Avenue. Our driveway is the first one just past the US-131 overpass on the left (north), through the fence gates. Our building is the largest one in this fenced area.

From the East or West

From I-94, exit onto US 131 North—go about 2.5 miles and take exit #36B onto Stadium Drive (west) towards Oshtemo—go ~0.5 miles
Turn right (north) on S. 11th Street (stop light)—go 0.1 miles
Turn right on W. Michigan Avenue (4-way stop sign)—go 0.3 miles and arrive at 5272 W. Michigan.

Our driveway is the first one just past the US-131 overpass on the left (north), through the fence gates. Our building is the largest one in this fenced area.